

PERFILS LIST - CRECHIE FINDER - TIPO 2 - BLOCO B				
ITEM	TAG	PERFIL	COMP. (mm)	QNTD.
1	CB1	UE 70	550	2
2	CB2	UE 70	280	4
3	TC1	UE 70	640	16
4	TC2	UE 70	740	10
5	TC3	UE 70	635	14
6	TC5	UE 70	905	7
7	TC6	UE 70	890	1
8	TC7	UE 70	1000	2
9	TC8	UE 70	850	3
10	TC9	TUBO UE 70	850	3
11	TR1	CAR 3020	8100	16
12	TR2	CAR 3020	2250	12
13	TR3	CAR 3020	1530	4
14	LVI	UE 70	300	34
15	RF1	UE 70	200	68
16	V1	DUPLO UE 150x60x20x3	8550	1
17	TS1	-	9050	14
18	TS3	-	3050	8
19	TS4	-	3400	2
20	TS6	-	8760	5
21	TS7	-	2352	3

PERFIS ISI - BLOK B					
PERFIS ISI - GRCHE FINE - TIPO 2 -					
ITEM	TAG	PERFIL	COMP. (mm)	QNTT	
1	C12	L 50x50	6000	14	4
2	CT1	L 50x50	2100	4	4
3	C13	L 50x50	2500	2500	4
4	CT4	L 50x50	2500	12	4
5	SF1	CAR 3020	5650	20	20
6	SF2	CAR 3020	4850	4	24
7	SF3	CAR 3020	6500	22	42
8	SF4	CAR 3020	4500	2	2
9	SF5	CAR 3020	2400	2	2
10	SF6	CAR 3020	6400	10	11
11	SF7	CAR 3020	3000	10	10
12	SF8	CAR 3020	3350	10	10
13	SF9	CAR 3020	4700	10	10
14	SF10	CAR 3020	6000	20	22
15	SF20	CAR 3020	6050	20	22

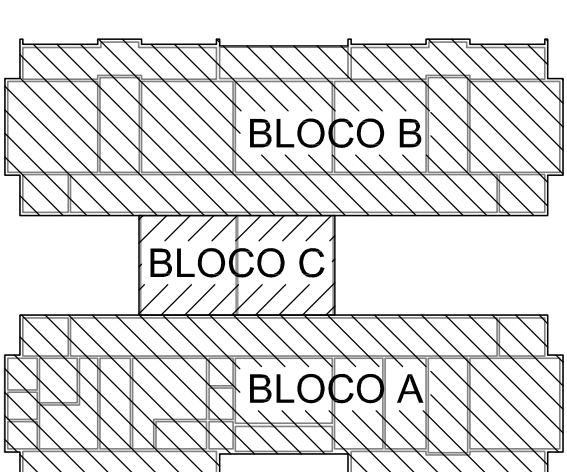

CONTROLE DE REVISÕES	
Nº	DATA
	DESCRIÇÃO
02	Alteração: a NRs 50/501, 51/51, 52/52, 53/53, 54/54, 55/55, 56/56, 57/57, 58/58, 59/59, 60/60, 61/61, 62/62, 63/63, 64/64, 65/65, 66/66, 67/67, 68/68, 69/69, 70/70, 71/71, 72/72, 73/73, 74/74, 75/75, 76/76, 77/77, 78/78, 79/79, 80/80, 81/81, 82/82, 83/83, 84/84, 85/85, 86/86, 87/87, 88/88, 89/89, 90/90, 91/91, 92/92, 93/93, 94/94, 95/95, 96/96, 97/97, 98/98, 99/99, 100/100, 101/101, 102/102, 103/103, 104/104, 105/105, 106/106, 107/107, 108/108, 109/109, 110/110, 111/111, 112/112, 113/113, 114/114, 115/115, 116/116, 117/117, 118/118, 119/119, 120/120, 121/121, 122/122, 123/123, 124/124, 125/125, 126/126, 127/127, 128/128, 129/129, 130/130, 131/131, 132/132, 133/133, 134/134, 135/135, 136/136, 137/137, 138/138, 139/139, 140/140, 141/141, 142/142, 143/143, 144/144, 145/145, 146/146, 147/147, 148/148, 149/149, 150/150, 151/151, 152/152, 153/153, 154/154, 155/155, 156/156, 157/157, 158/158, 159/159, 160/160, 161/161, 162/162, 163/163, 164/164, 165/165, 166/166, 167/167, 168/168, 169/169, 170/170, 171/171, 172/172, 173/173, 174/174, 175/175, 176/176, 177/177, 178/178, 179/179, 180/180, 181/181, 182/182, 183/183, 184/184, 185/185, 186/186, 187/187, 188/188, 189/189, 190/190, 191/191, 192/192, 193/193, 194/194, 195/195, 196/196, 197/197, 198/198, 199/199, 200/200, 201/201, 202/202, 203/203, 204/204, 205/205, 206/206, 207/207, 208/208, 209/209, 210/210, 211/211, 212/212, 213/213, 214/214, 215/215, 216/216, 217/217, 218/218, 219/219, 220/220, 221/221, 222/222, 223/223, 224/224, 225/225, 226/226, 227/227, 228/228, 229/229, 230/230, 231/231, 232/232, 233/233, 234/234, 235/235, 236/236, 237/237, 238/238, 239/239, 240/240, 241/241, 242/242, 243/243, 244/244, 245/245, 246/246, 247/247, 248/248, 249/249, 250/250, 251/251, 252/252, 253/253, 254/254, 255/255, 256/256, 257/257, 258/258, 259/259, 260/260, 261/261, 262/262, 263/263, 264/264, 265/265, 266/266, 267/267, 268/268, 269/269, 270/270, 271/271, 272/272, 273/273, 274/274, 275/275, 276/276, 277/277, 278/278, 279/279, 280/280, 281/281, 282/282, 283/283, 284/284, 285/285, 286/286, 287/287, 288/288, 289/289, 290/290, 291/291, 292/292, 293/293, 294/294, 295/295, 296/296, 297/297, 298/298, 299/299, 300/300, 301/301, 302/302, 303/303, 304/304, 305/305, 306/306, 307/307, 308/308, 309/309, 310/310, 311/311, 312/312, 313/313, 314/314, 315/315, 316/316, 317/317, 318/318, 319/319, 320/320, 321/321, 322/322, 323/323, 324/324, 325/325, 326/326, 327/327, 328/328, 329/329, 330/330, 331/331, 332/332, 333/333, 334/334, 335/335, 336/336, 337/337, 338/338, 339/339, 340/340, 341/341, 342/342, 343/343, 344/344, 345/345, 346/346, 347/347, 348/348, 349/349, 350/350, 351/351, 352/352, 353/353, 354/354, 355/355, 356/356, 357/357, 358/358, 359/359, 360/360, 361/361, 362/362, 363/363, 364/364, 365/365, 366/366, 367/367, 368/368, 369/369, 370/370, 371/371, 372/372, 373/373, 374/374, 375/375, 376/376, 377/377, 378/378, 379/379, 380/380, 381/381, 382/382, 383/383, 384/384, 385/385, 386/386, 387/387, 388/388, 389/389, 390/390, 391/391, 392/392, 393/393, 394/394, 395/395, 396/396, 397/397, 398/398, 399/399, 400/400, 401/401, 402/402, 403/403, 404/404, 405/405, 406/406, 407/407, 408/408, 409/409, 410/410, 411/411, 412/412, 413/413, 414/414, 415/415, 416/416, 417/417, 418/418, 419/419, 420/420, 421/421, 422/422, 423/423, 424/424, 425/425, 426/426, 427/427, 428/428, 429/429, 430/430, 431/431, 432/432, 433/433, 434/434, 435/435, 436/436, 437/437, 438/438, 439/439, 440/440, 441/441, 442/442, 443/443, 444/444, 445/445, 446/446, 447/447, 448/448, 449/449, 450/450, 451/451, 452/452, 453/453, 454/454, 455/455, 456/456, 457/457, 458/458, 459/459, 460/460, 461/461, 462/462, 463/463, 464/464, 465/465, 466/466, 467/467, 468/468, 469/469, 470/470, 471/471, 472/472, 473/473, 474/474, 475/475, 476/476, 477/477, 478/478, 479/479, 480/480, 481/481, 482/482, 483/483, 484/484, 485/485, 486/486, 487/487, 488/488, 489/489, 490/490, 491/491, 492/492, 493/493, 494/494, 495/495, 496/496, 497/497, 498/498, 499/499, 500/500, 501/501, 502/502, 503/503, 504

PROJETO PADRÃO - FNDE	
PROPRIETÁRIO: _____	
ENDEREÇO: _____	
MUNICÍPIO – UF: _____	
PROPRIETÁRIO _____	
RESP. TÉCNICO _____	CREA _____
AUTOR DO PROJETO _____	CAU _____

CREA	DUFO
RA	

OBSERVAÇÕES:
PROGRAMA PROINFÂNCIA - PROJETO TIPO 2
PROJETO DE ESTRUTURA

COORDENAÇÃO CGEST - Coordenação Geral de Infraestrutura Educativa	<p align="center">ESTRUTURA METÁLICA</p> <p align="center">ESTRUTURA DA COBERTURA E DO FORRO</p> <p align="center">BLOCO B</p>			<p align="center">SMT</p>
REVISÃO	ESCALA		PRIMEIRA	
R.00	1/75			
R.01				
DATA EMISSÃO				
03/10/2022				
FORNADO				03/10

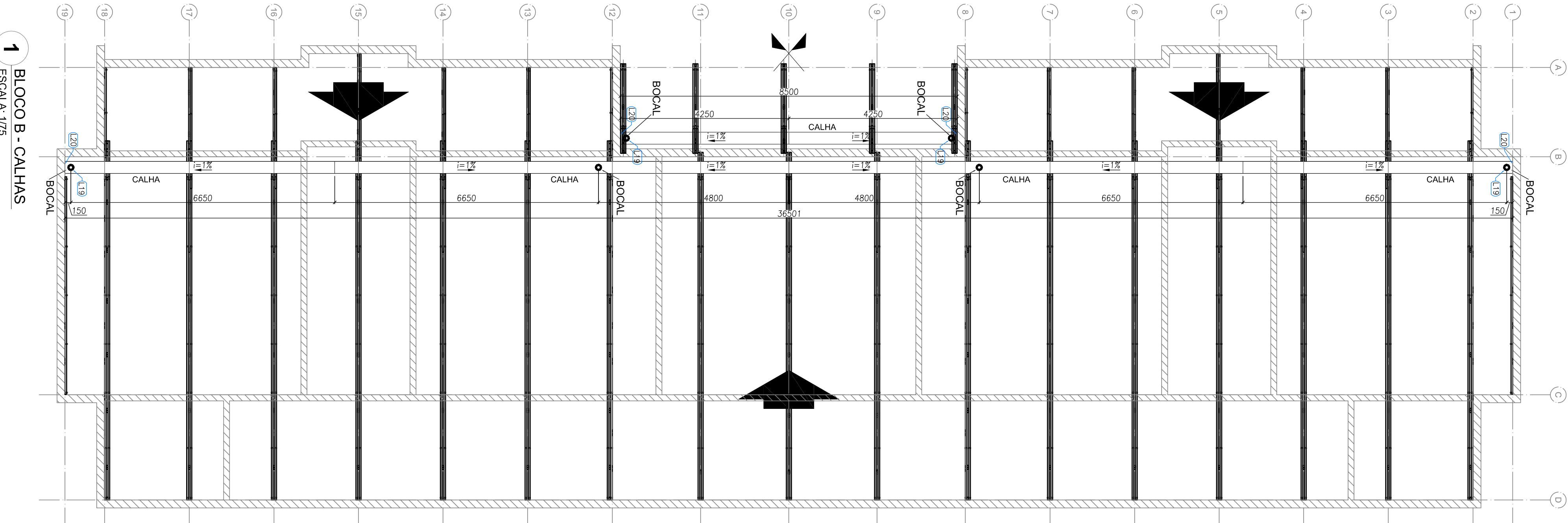

1 BLOCO B - CALHAS
ESCALA: 1/75

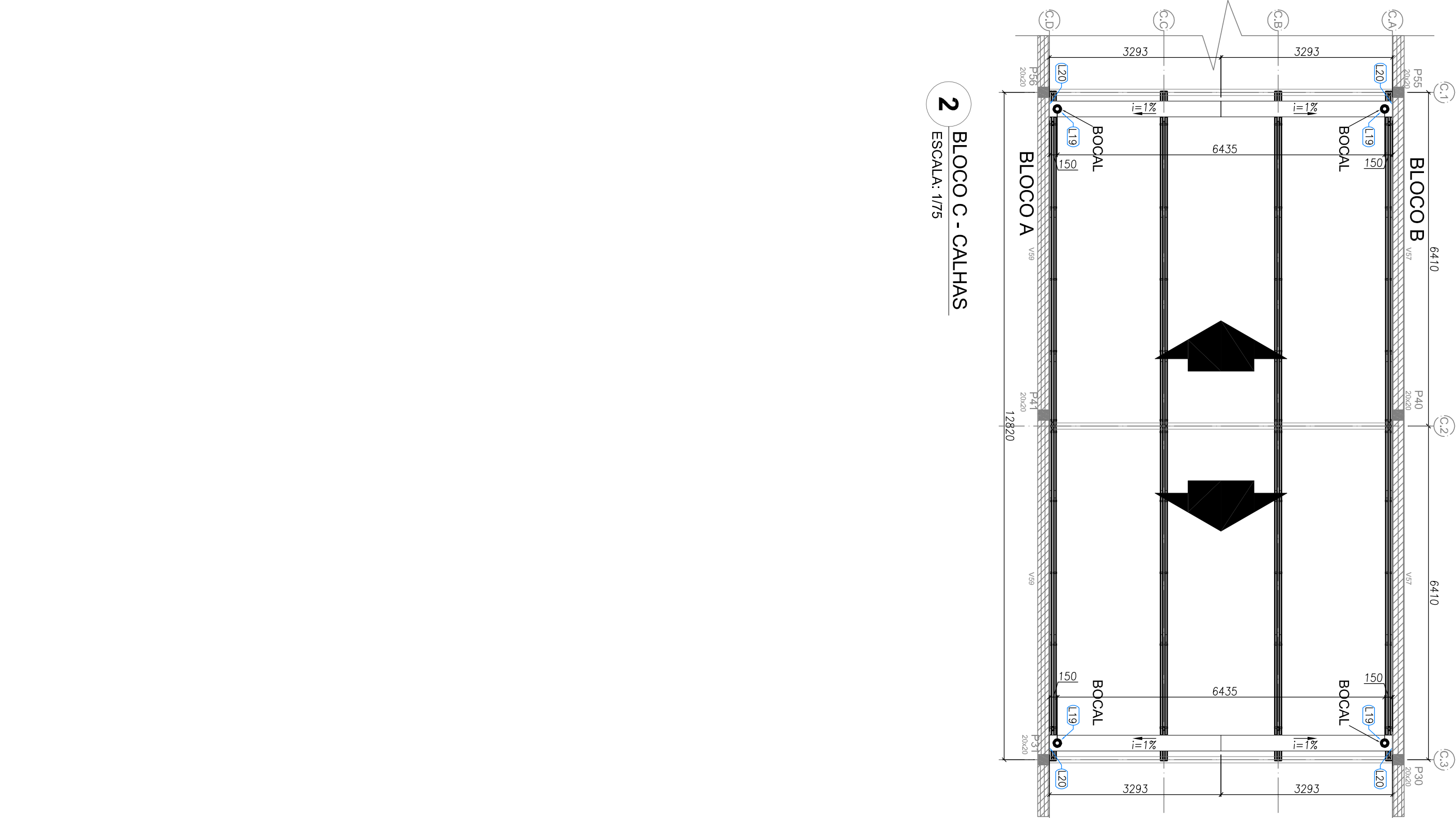

2 BLOCO C - CALHAS
ESCALA: 1/75

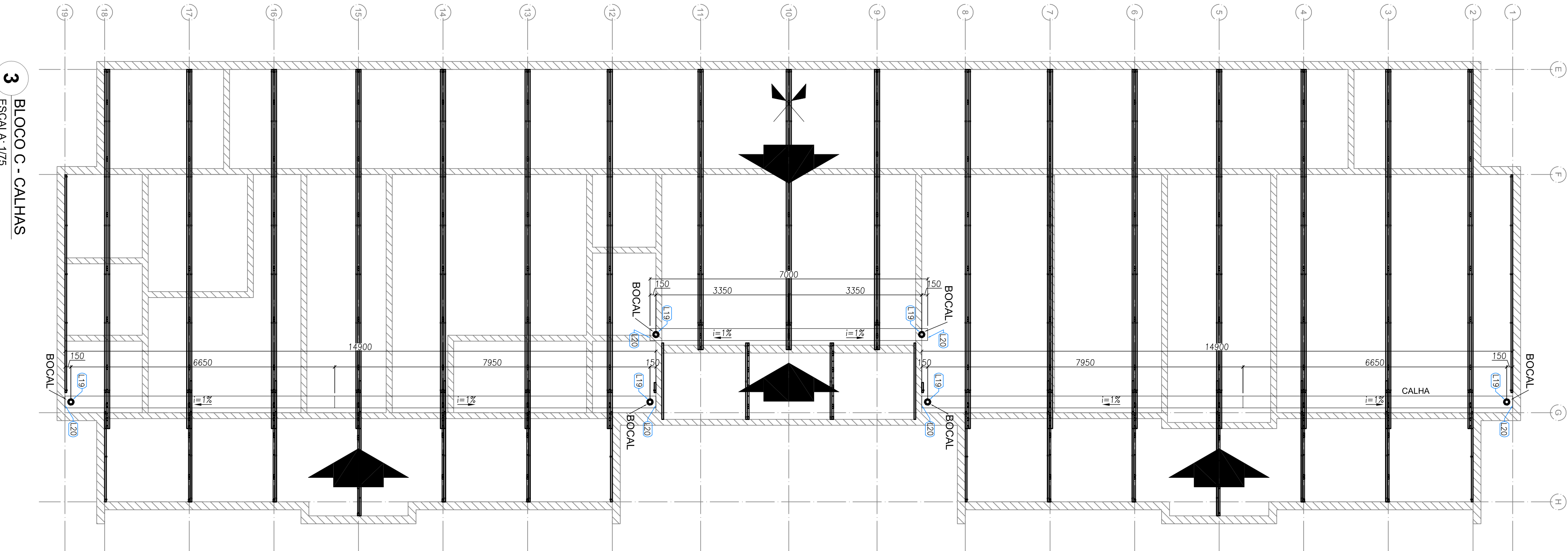

3 BLOCO C - CALHAS
ESCALA: 1/75

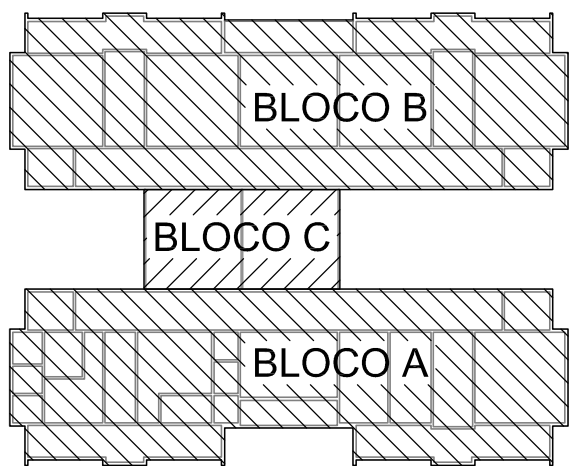

02	JANEIRO/ 2017	Atendimento à NBR 9190/ 2015.
01	AGOSTO/ 2016	Adequação quanto de áreas, sanitários internos e 2, altura da platibanda, mobiliário e equipamento, altura da cerâmica nos sanitários, cor dos portões dos sanitários e altura da porta PA4, Adequação das condições higiênicas e sanitárias pre-existente, Revisão da altura de apoio abelo da platibanda, Cor dos sanitários, Bloco B34, B36, Sanitários B34, B36, Pluviais P33, P45, P57, Vigas nível 310, V22, V45, V75, Supressão, Viga nível 310, V72.
Nº	DATA	DESCRIÇÃO

CONTROLE DE REVISÕES

FNDE *Fundo Nacional de Desenvolvimento da Educação*

Ministério da Educação

PROJETO PADRÃO - FNDE

PROPRIETÁRIO: :

ENDEREÇO:

MUNICÍPIO – UF:

PROPRIETÁRIO

RESP. TÉCNICO

AUTOR DO PROJETO

CREA

CREA

CREA

RA

OBSERVAÇÕES:

PROGRAMA PROINFÂNCIA - PROJETO TIPO 2
PROJETO DE ESTRUTURA

COORDENAÇÃO		ESTRUTURA METÁLICA		PRORANCA
CGEST - Coordenação Geral de Infraestrutura Educatcional		PLANTA DE COBERTURA - CALHAS BLOCO A, BLOCO B E BLOCO C		
		SMT		
FORMATO	AT (90x44x11)	REVISÃO	ESCALA	05/10
R.00	R.02	R.01	1/75	
DATA EMISSÃO		JANEIRO/2017		

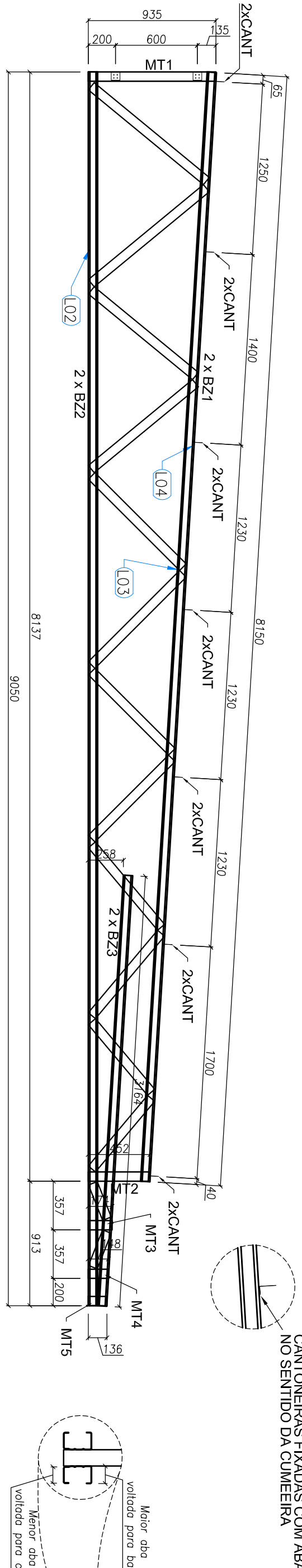

VISTA FRONTAL - BANZOS, MONTANTES e CANTONEIRAS

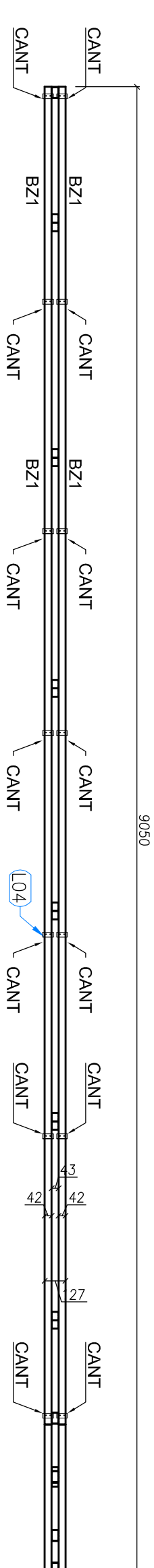
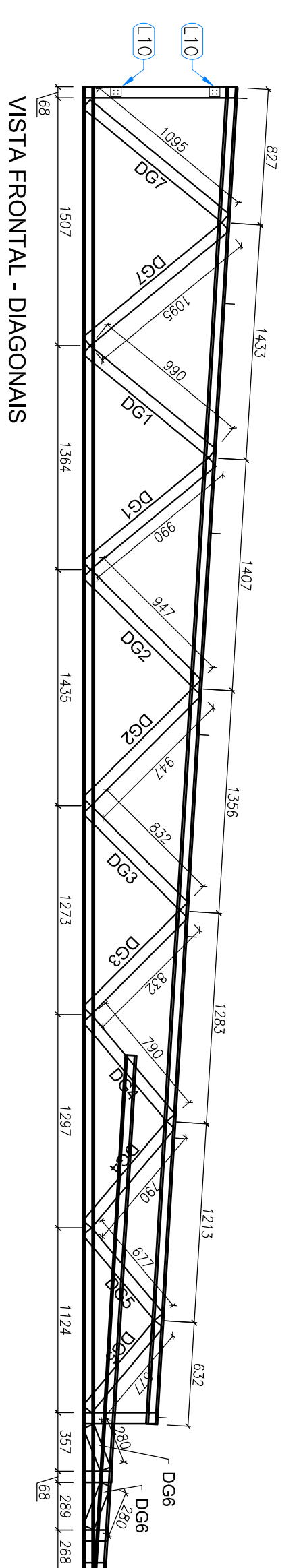

1 TS1 - (x28)
SEM ESCALA

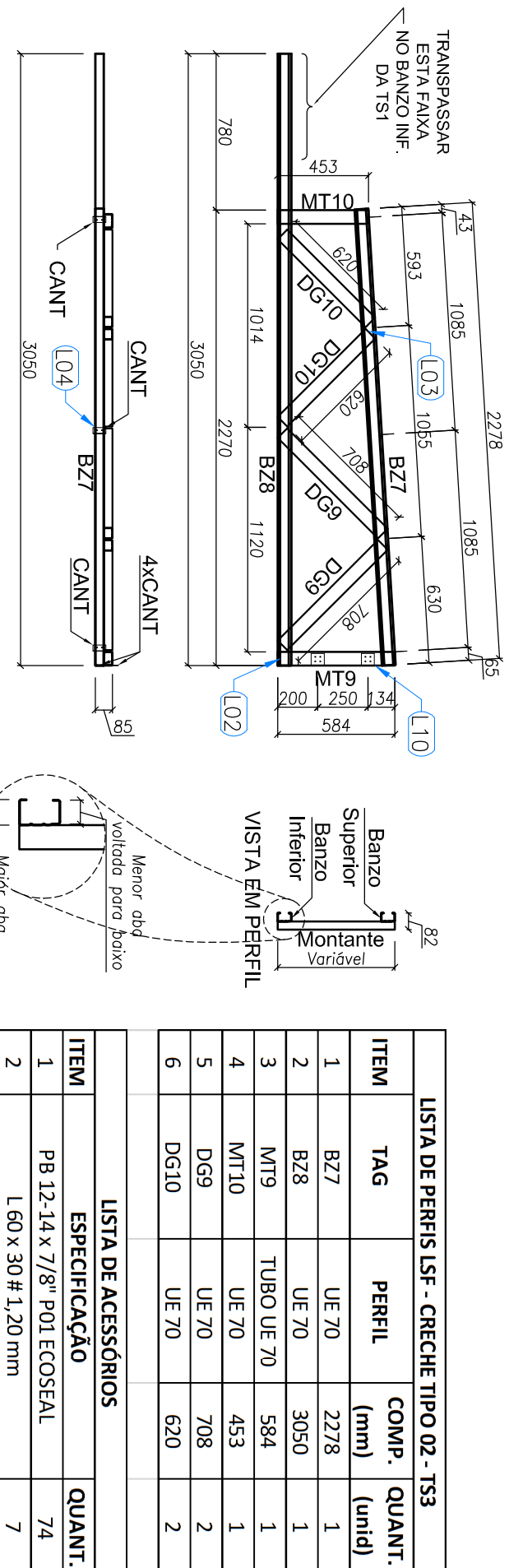

2 TS3 - (x16)
SEM ESCALA

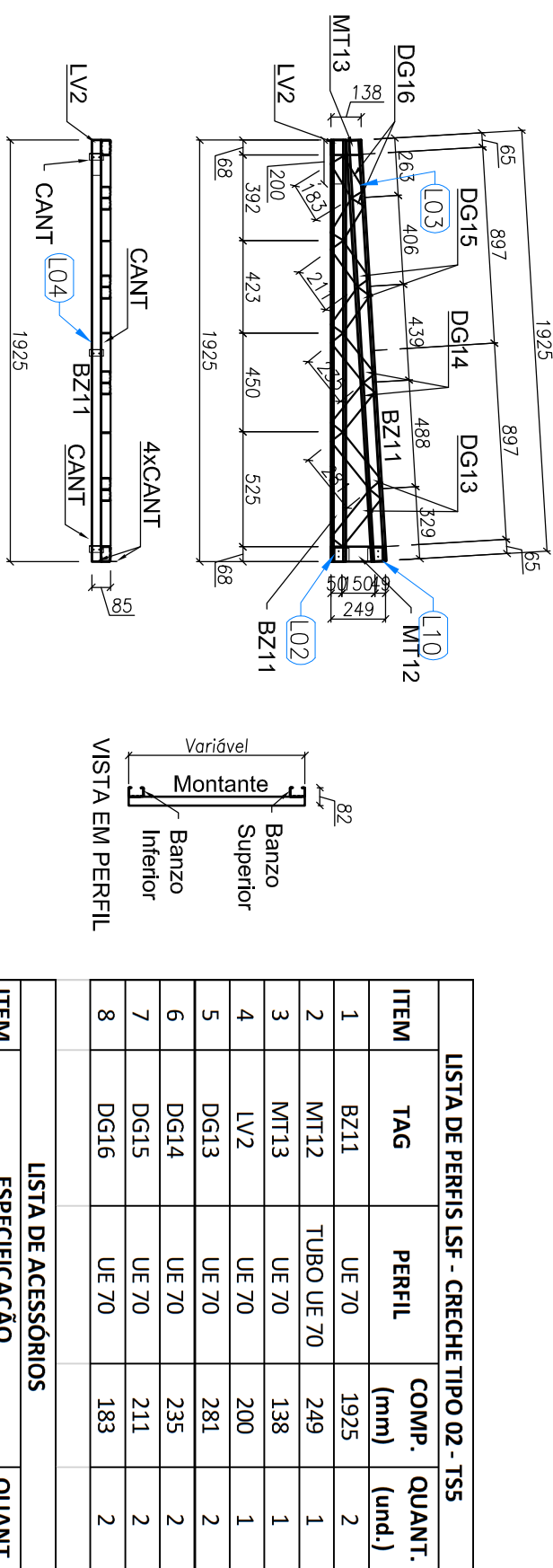

3 TS5 - (x02)
SEM ESCALA

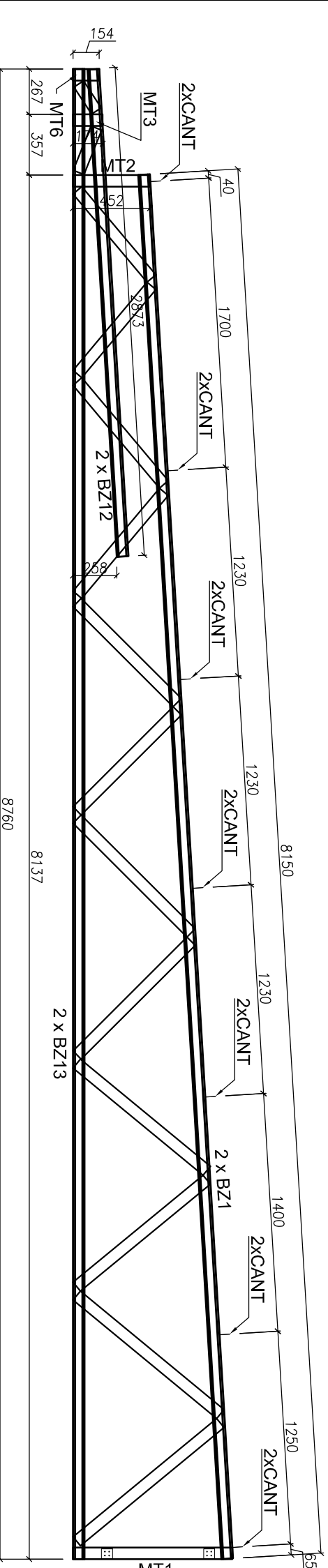

VISTA FRONTAL - BANZOS, MONTANTES e CANTONEIRAS

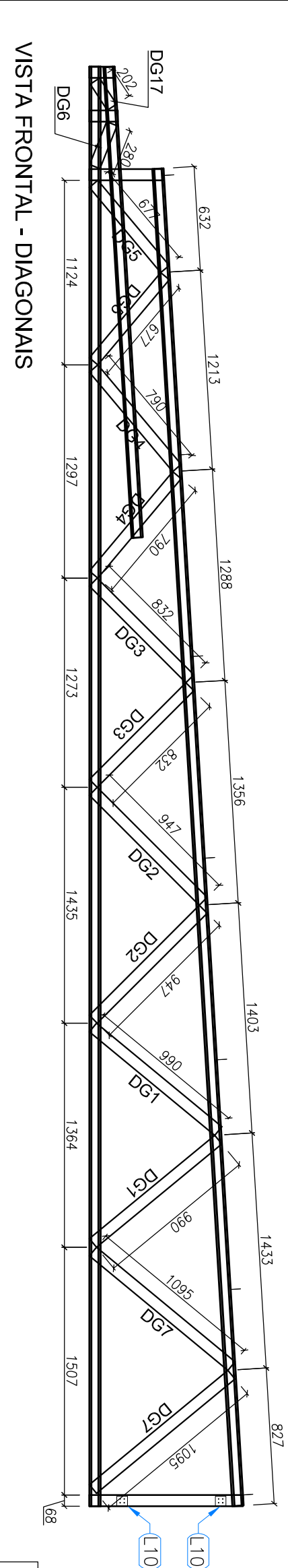

VISTA FRONTAL - DIAGONAIS

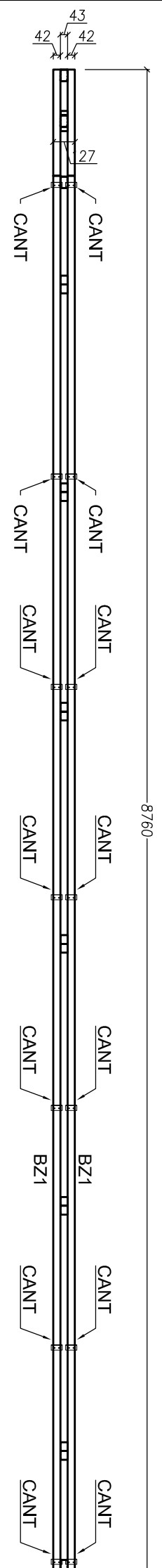

4 TS6 - (X03)
SEM ESCALA

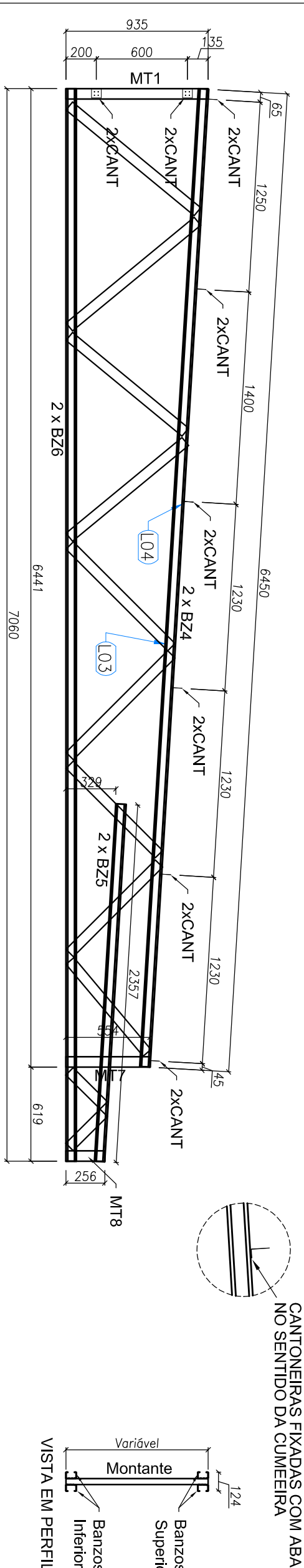

VISTA FRONTAL - BANZOS, MONTANTES e CANTONEIRAS

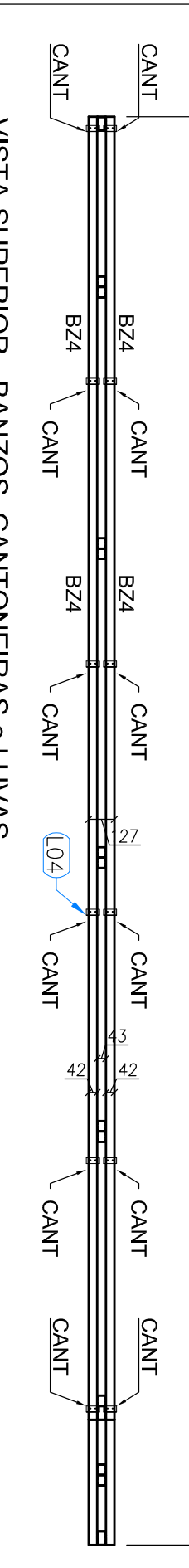
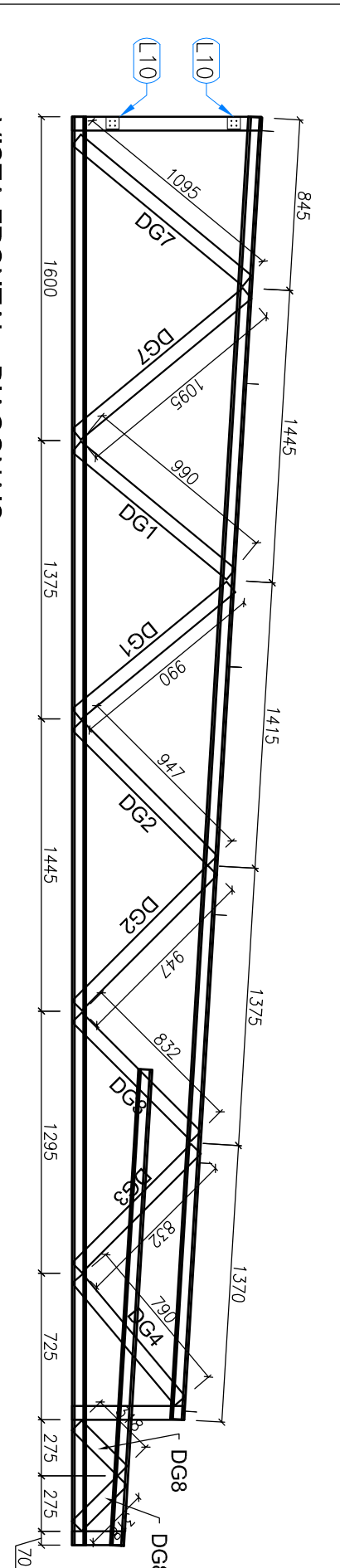

5 TS2 - (x03)
SEM ESCALA

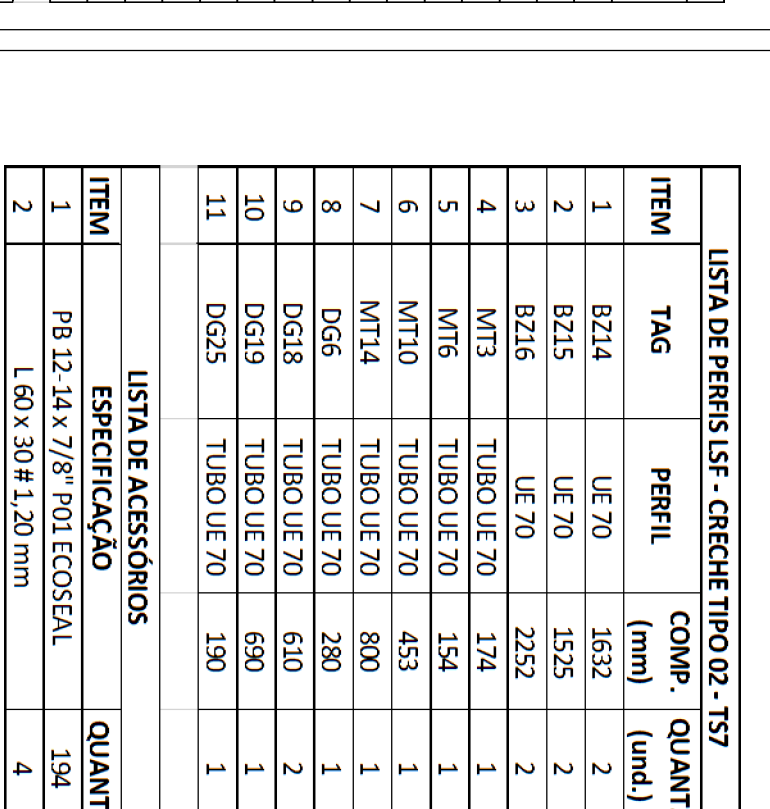
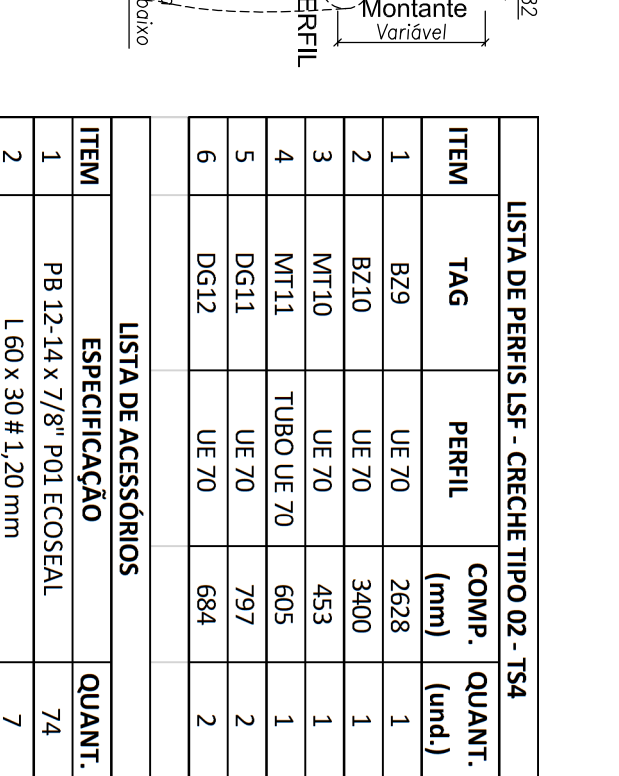

1	FB12-14X / 8 F01EC03EAL
2	L 60 x 30 #1,20 mm

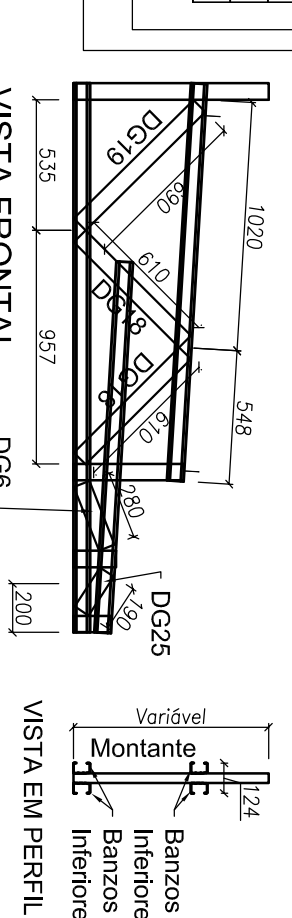
[illegible]



FND

Fundo Nacional da Educação

Ministério da Educação

PROJETO PADRÃO - FND

PROJETANDO : _____

EXECUÇÃO : _____

MONITORIO - UF: _____

PROPRIETARIO	
RESP. TÉCNICO	GRSA
AUTOR DO PROJETO	GAU
DATA	07/04

OBSERVAÇÕES:			
COORDENADOR CEGEST - Coordenação de Gerenciamento Educacional		ESTRUTURA METACLA AMPLIAÇÕES DAS TEÓRICAS TS1, TS2, TS3, TS4, TS6 E TS7	
TÍTULO 4.10.1 TS2	ESCALA INICIAL SMT - SÉRIAS INICIAIS	PROPOSTA 06/10	

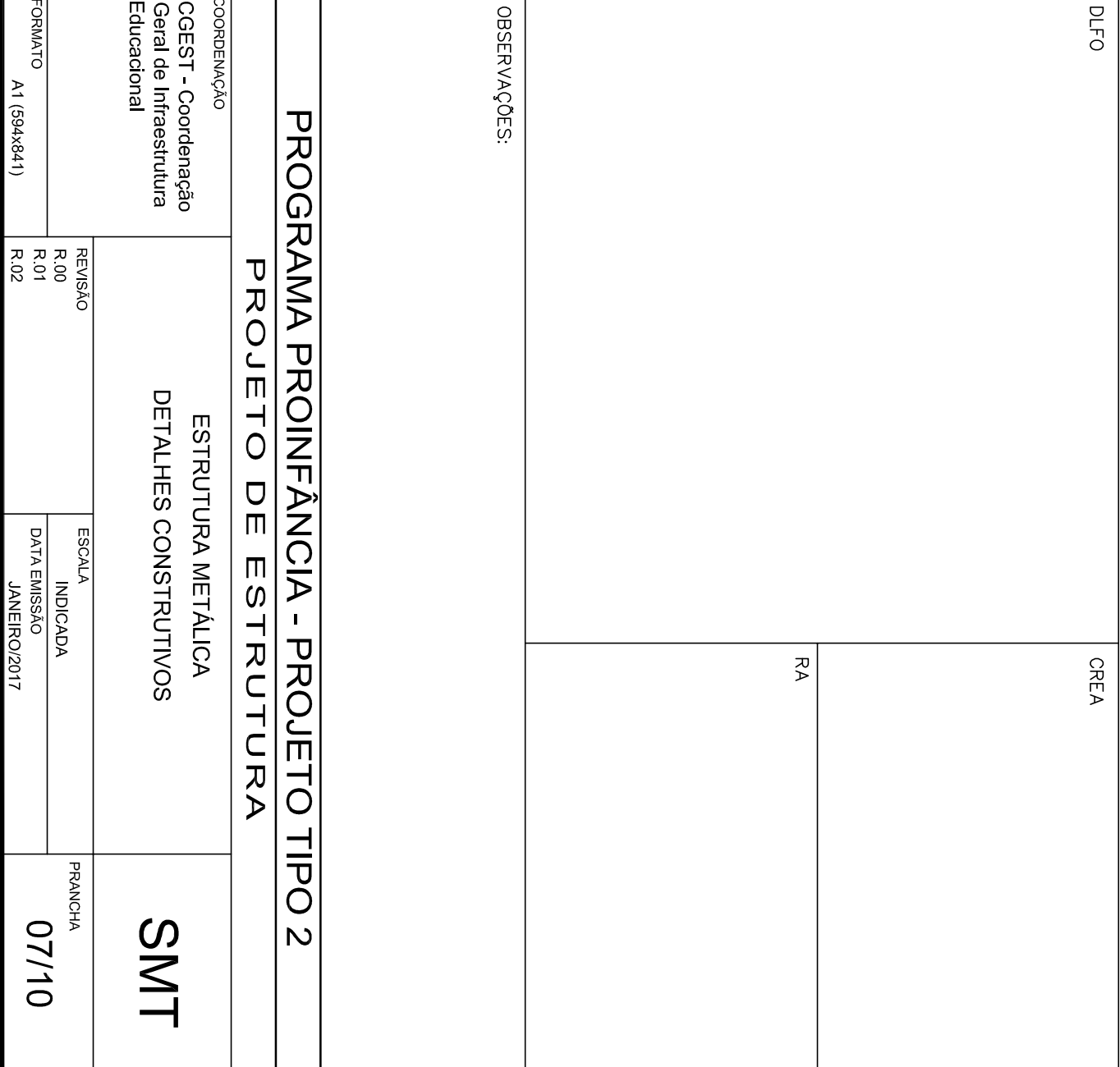
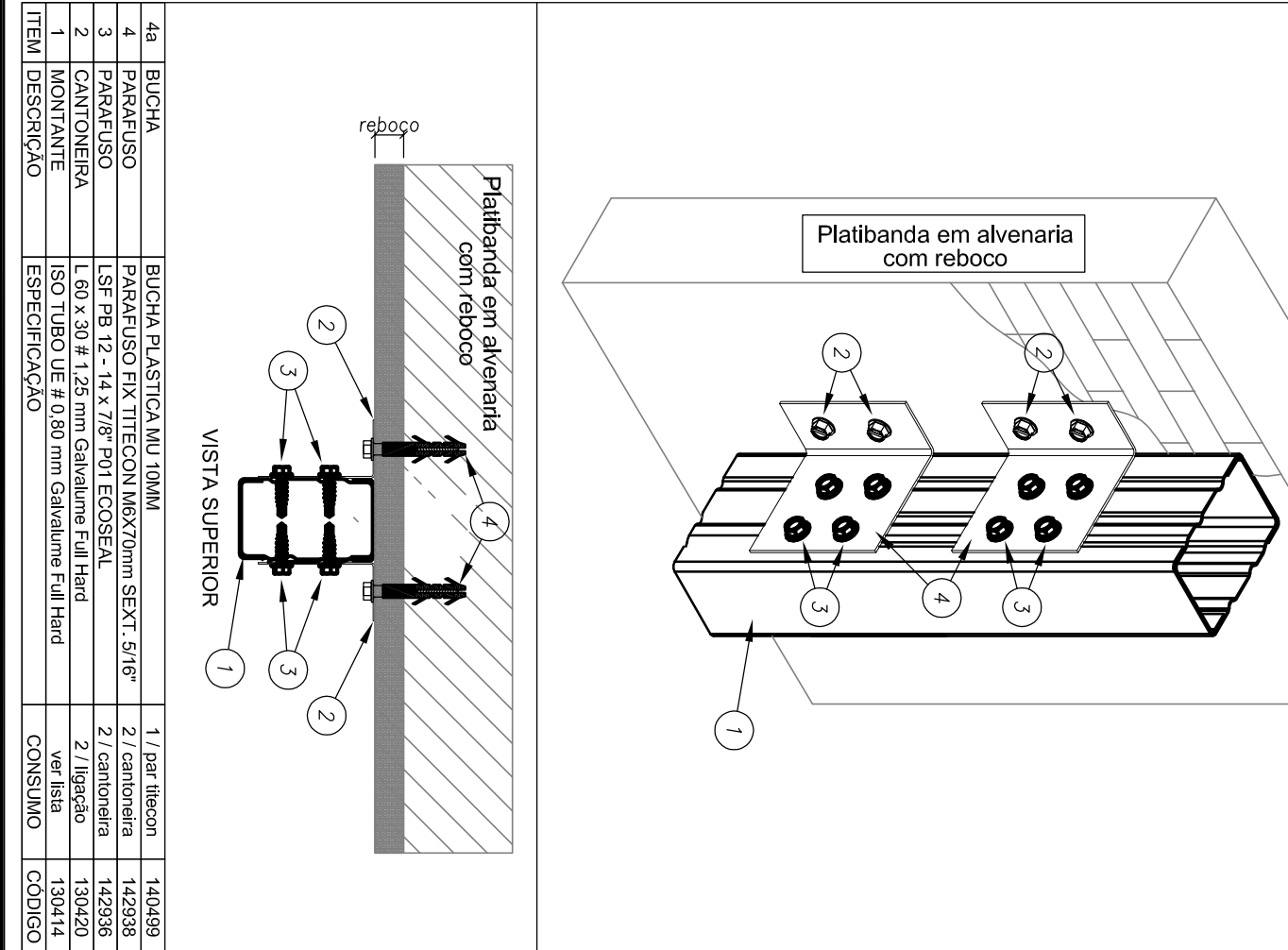
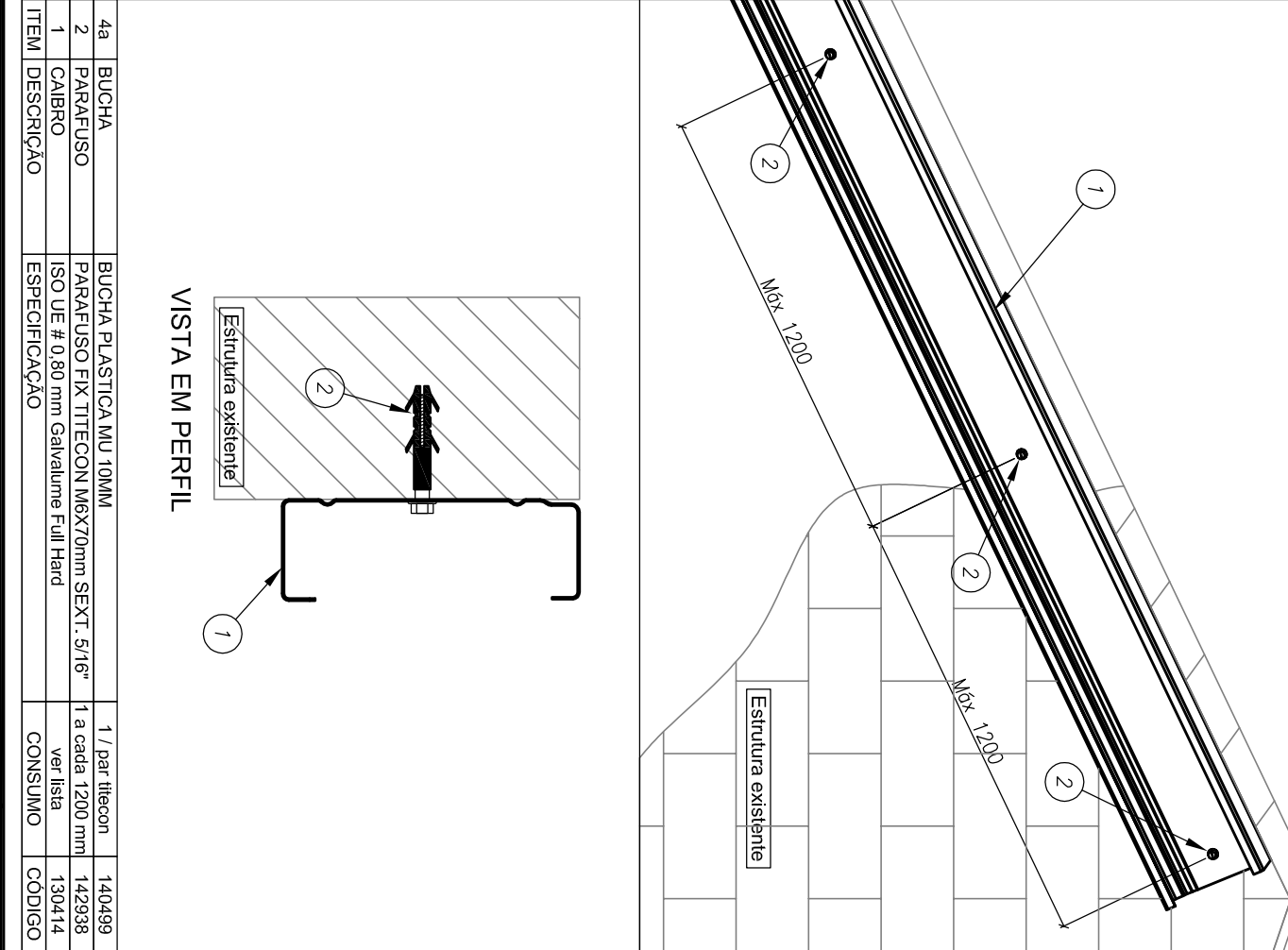
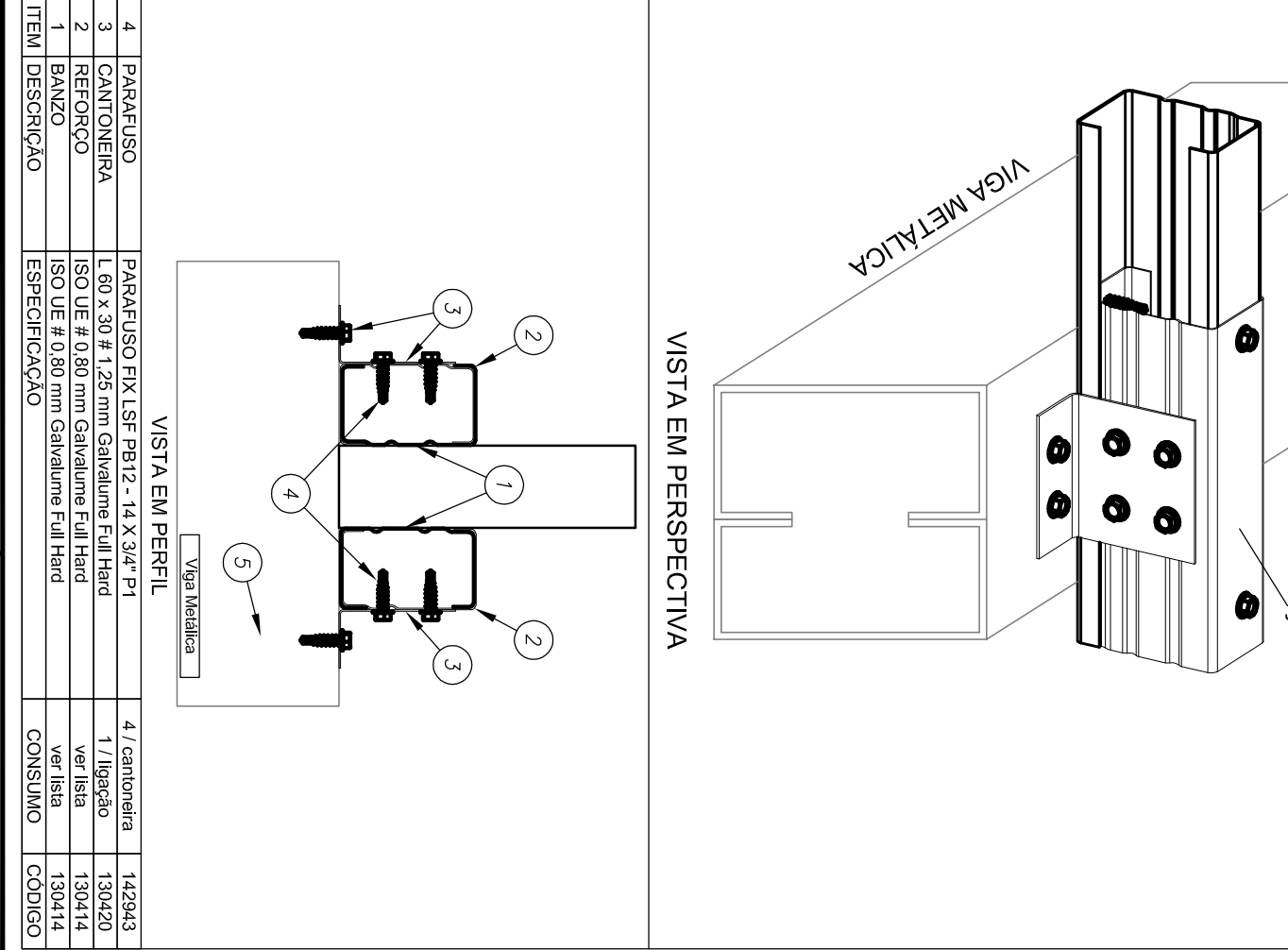
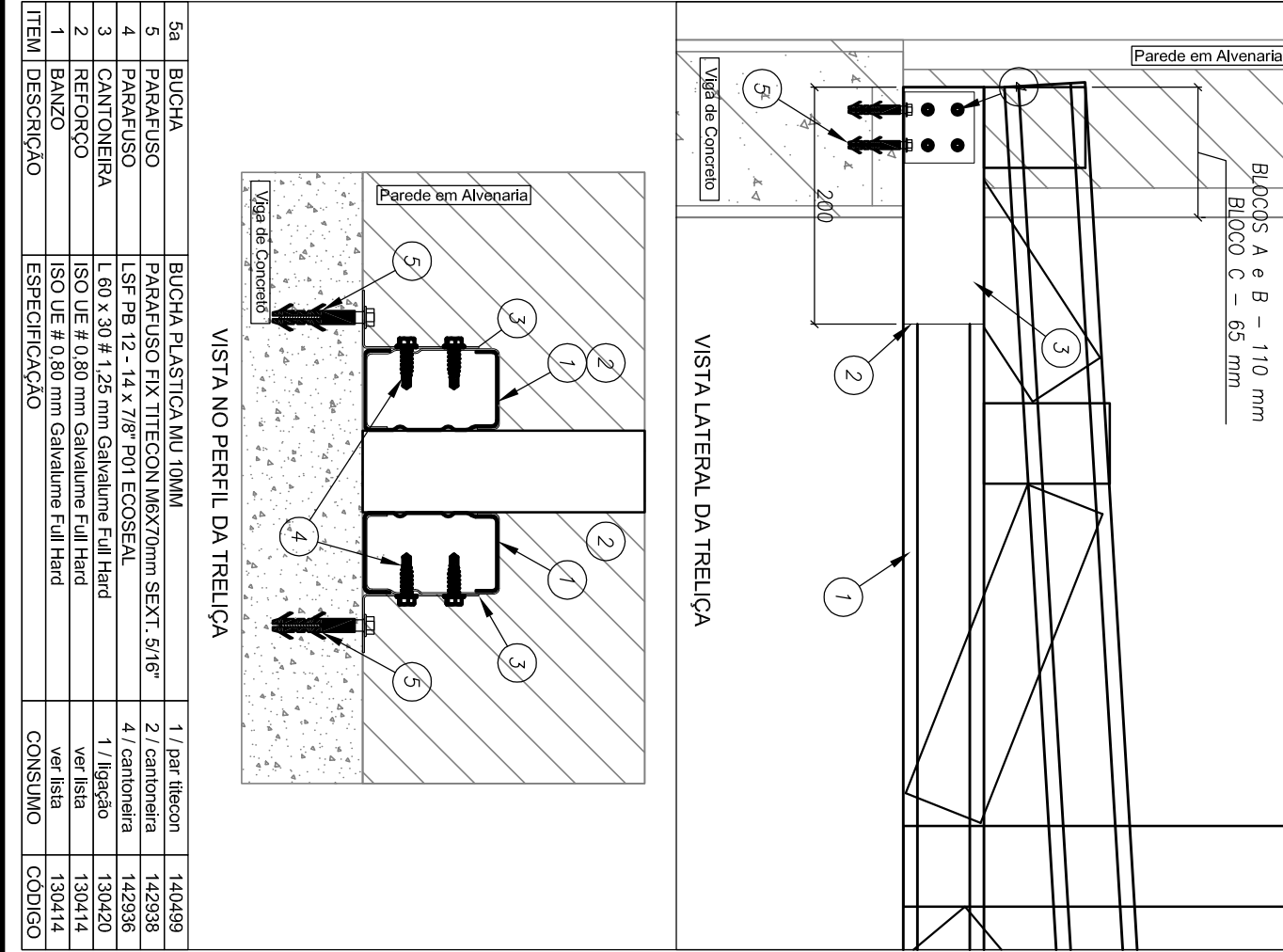
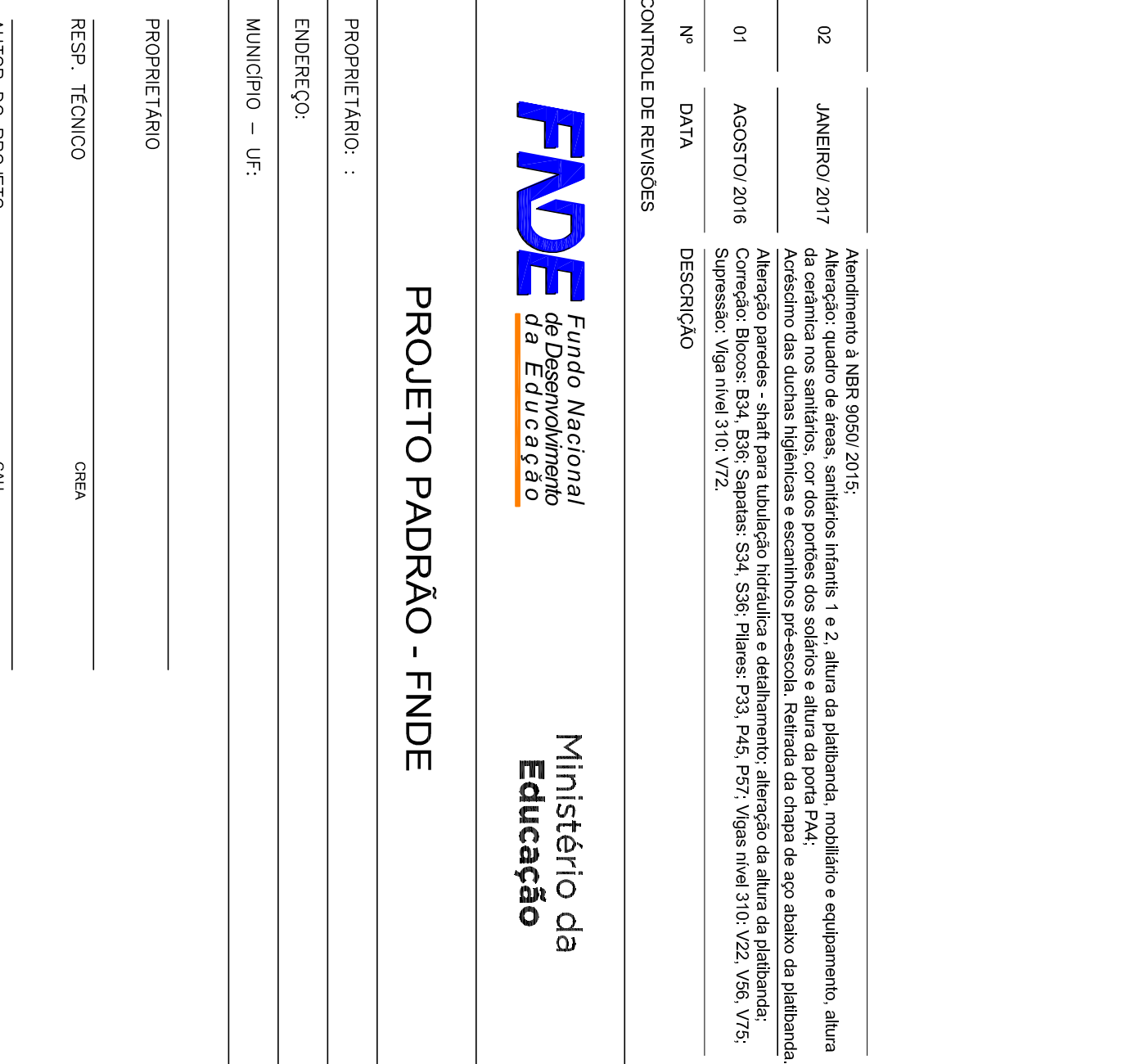
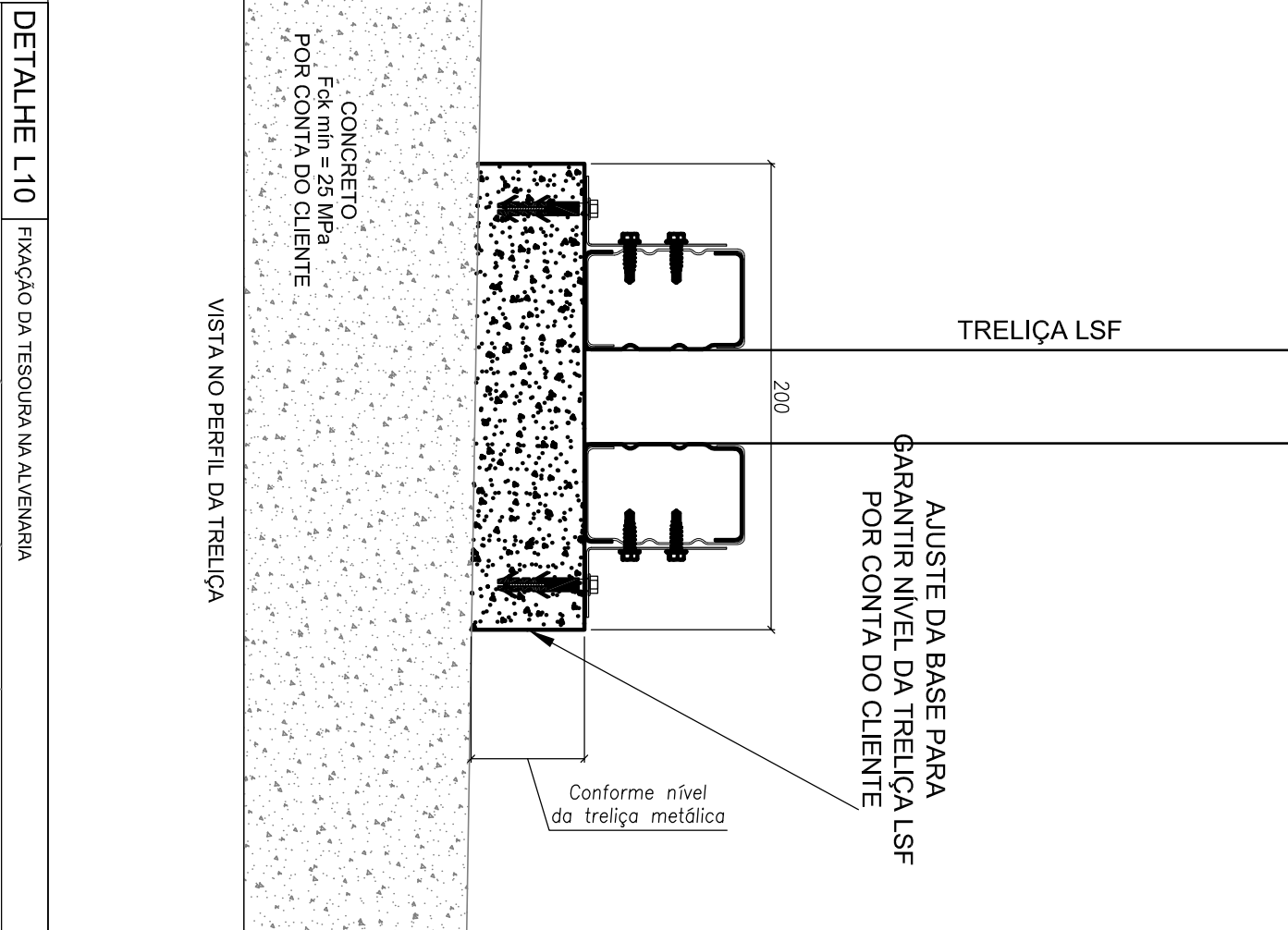
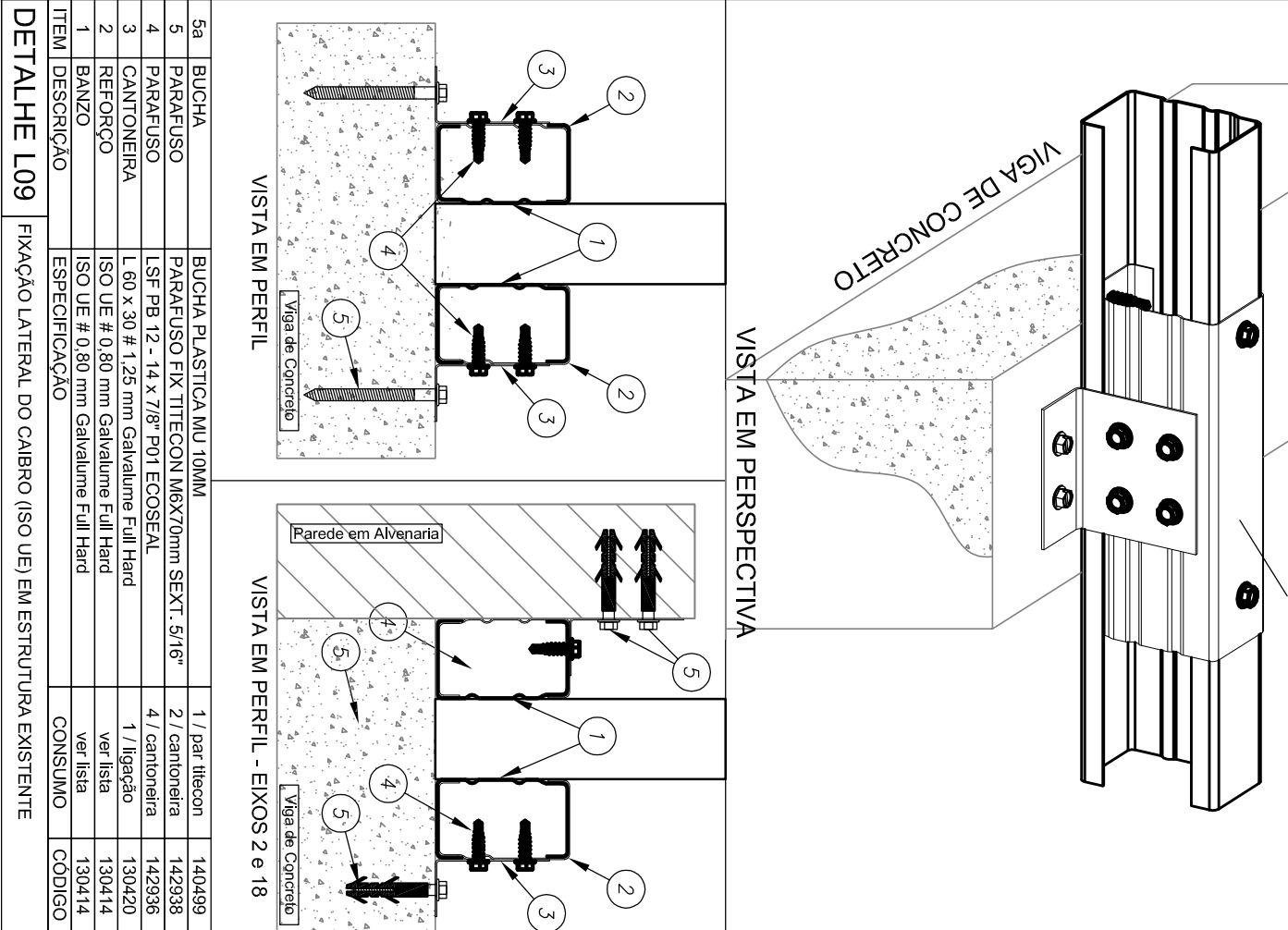
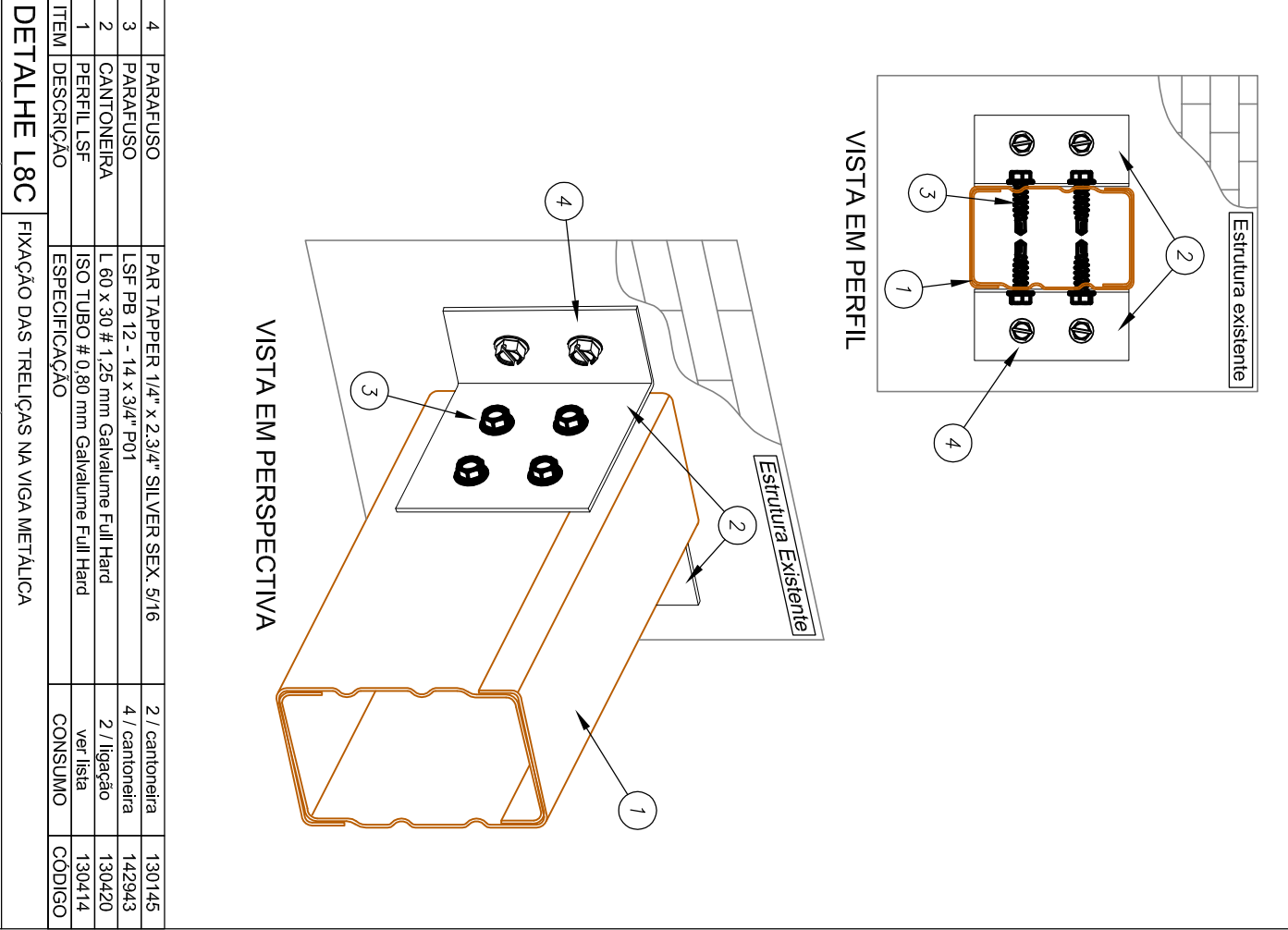
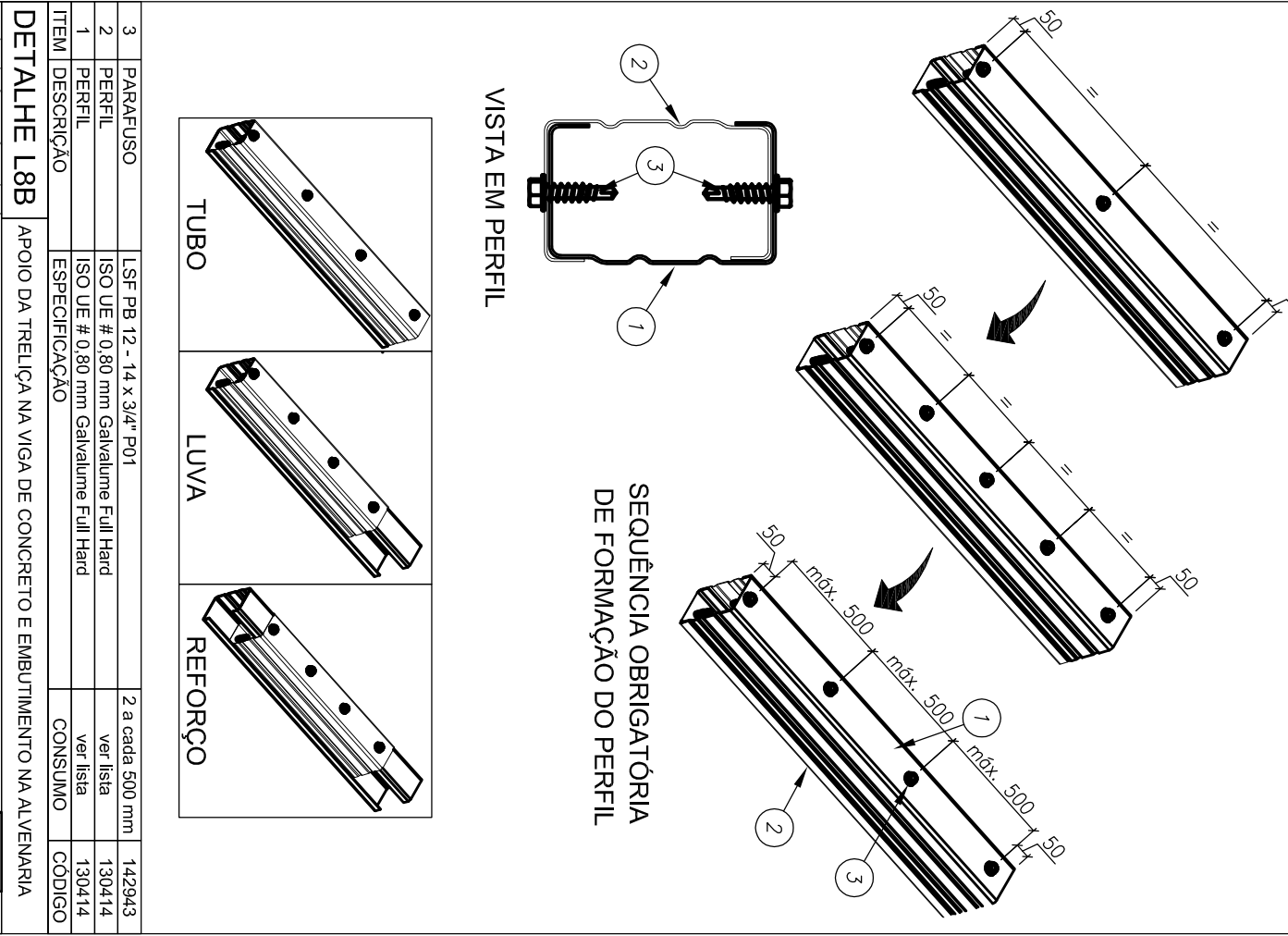
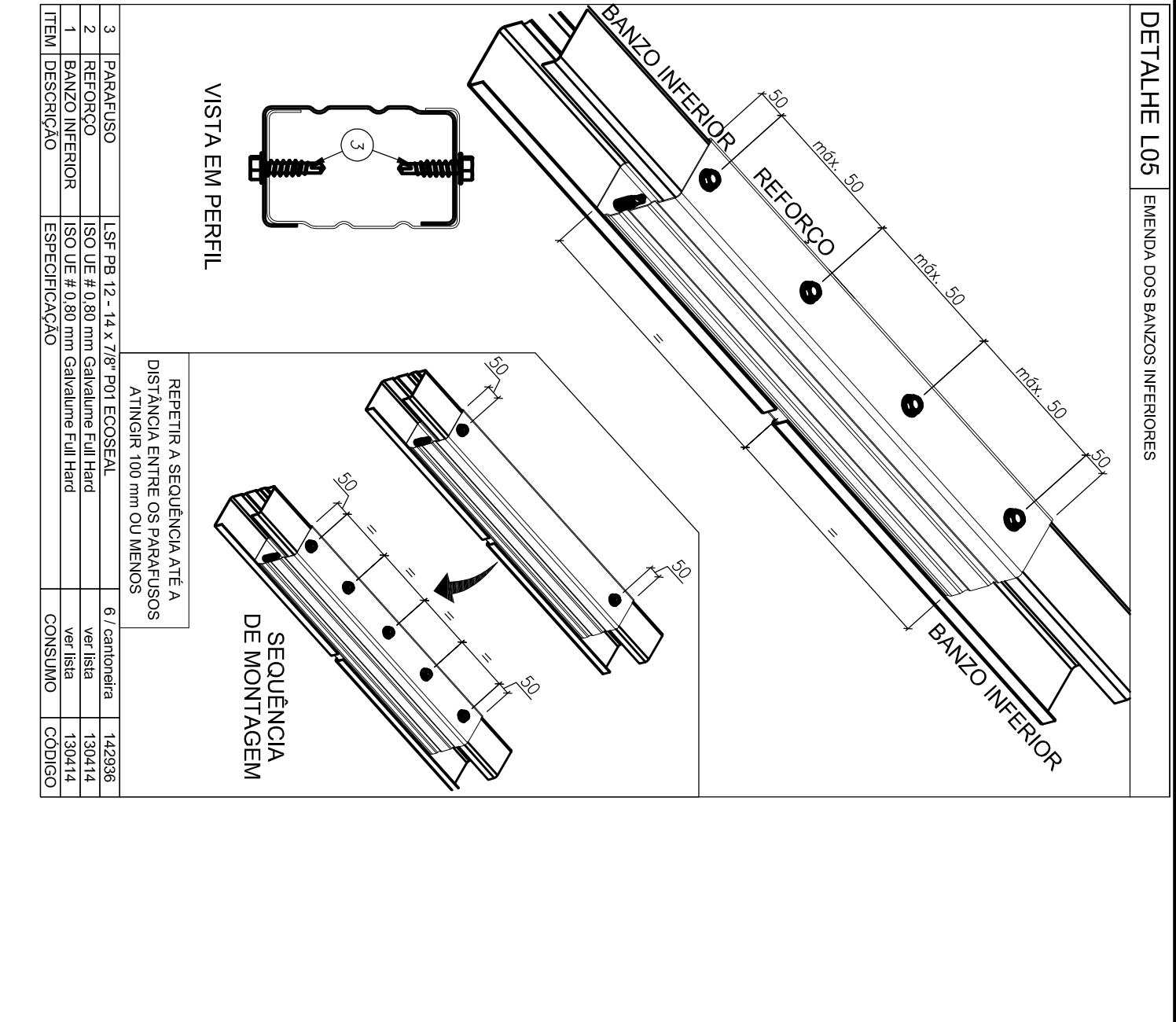
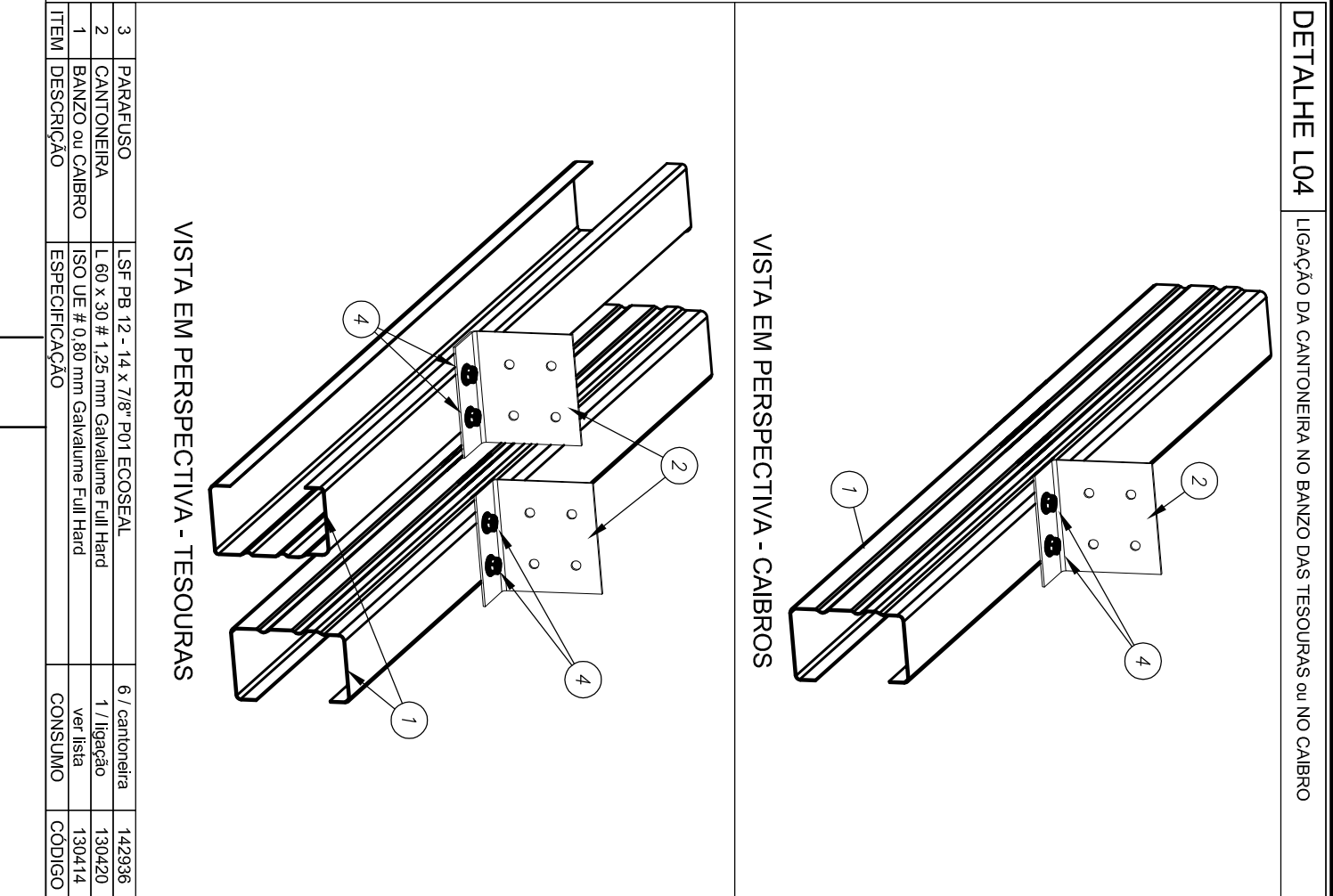
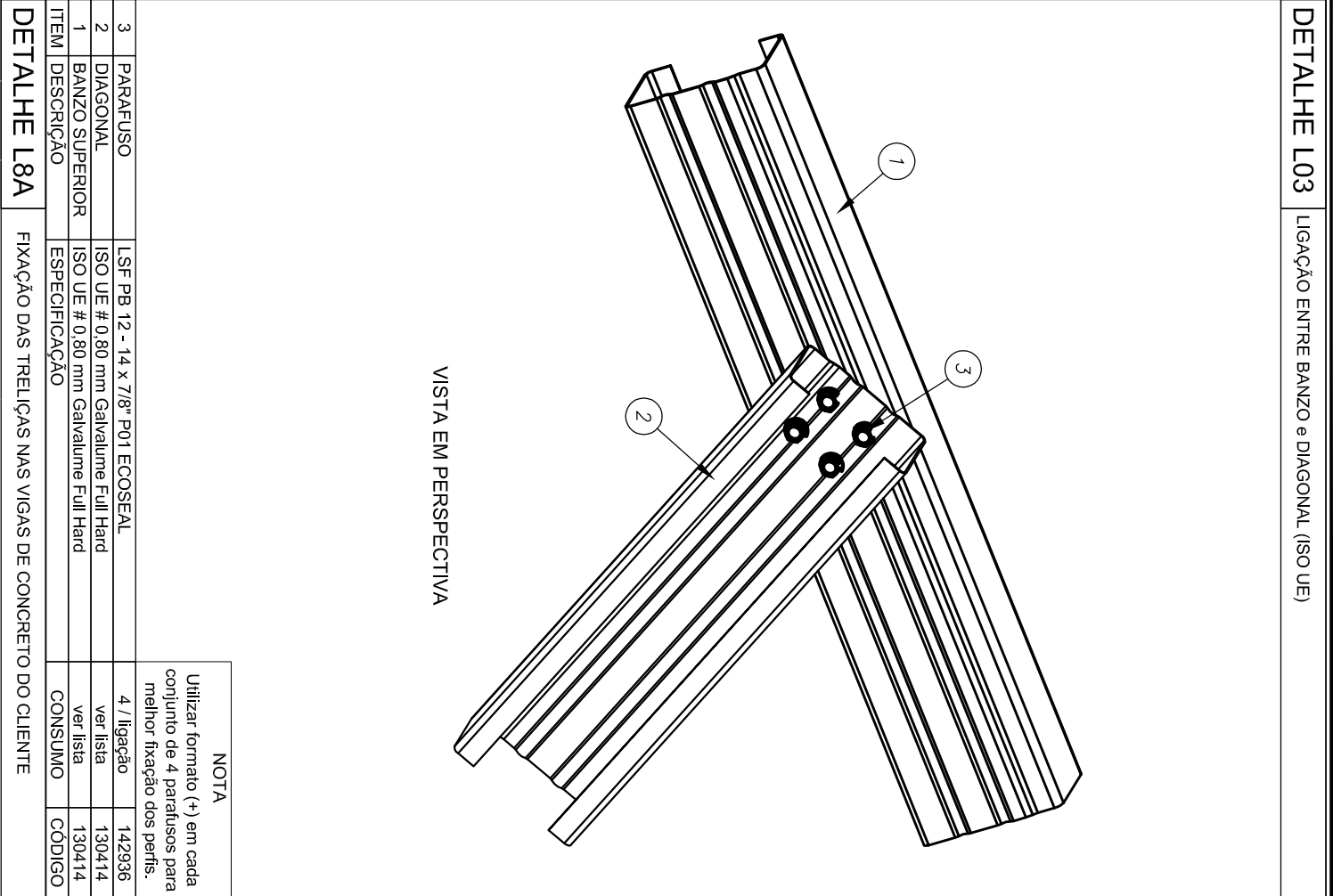
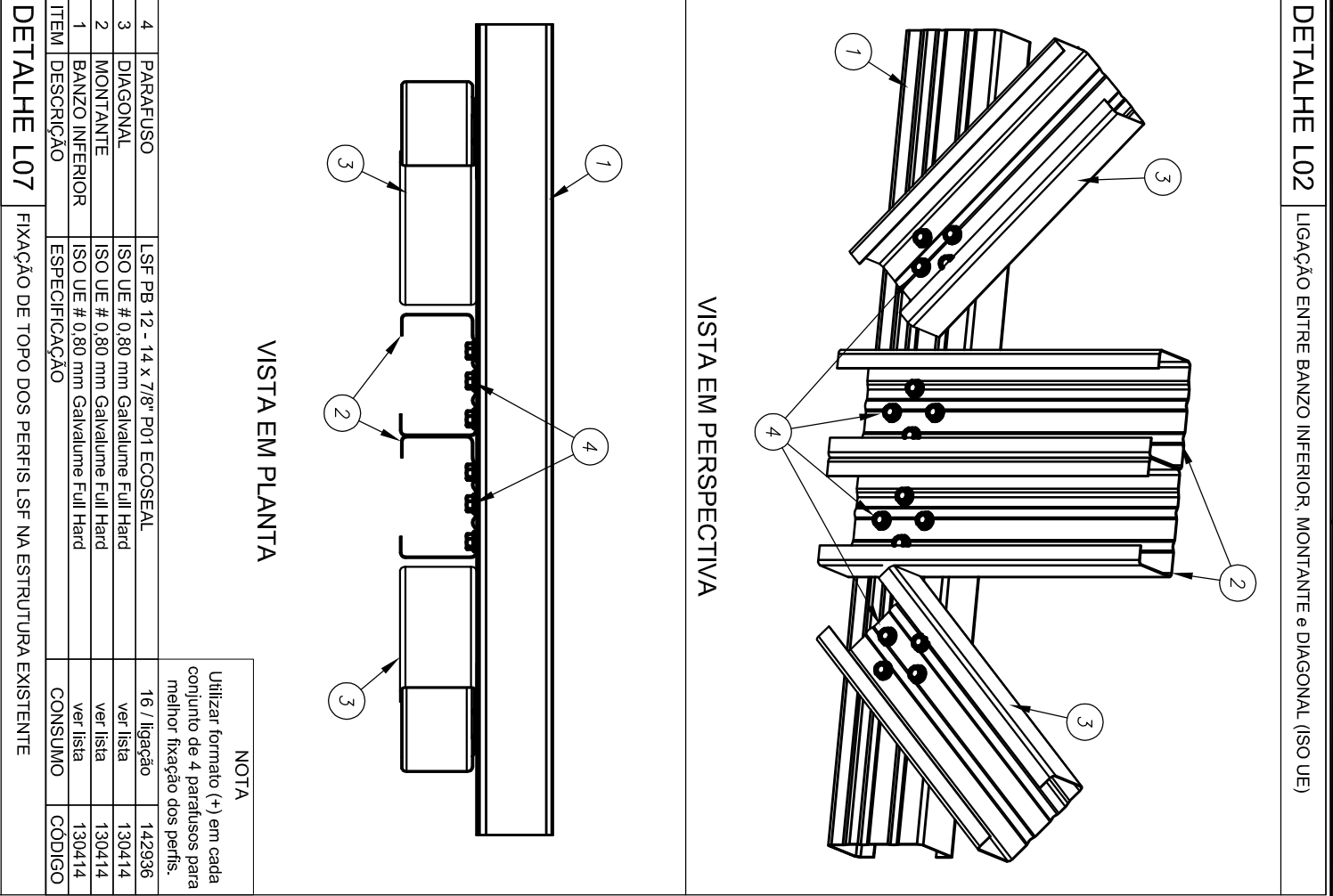
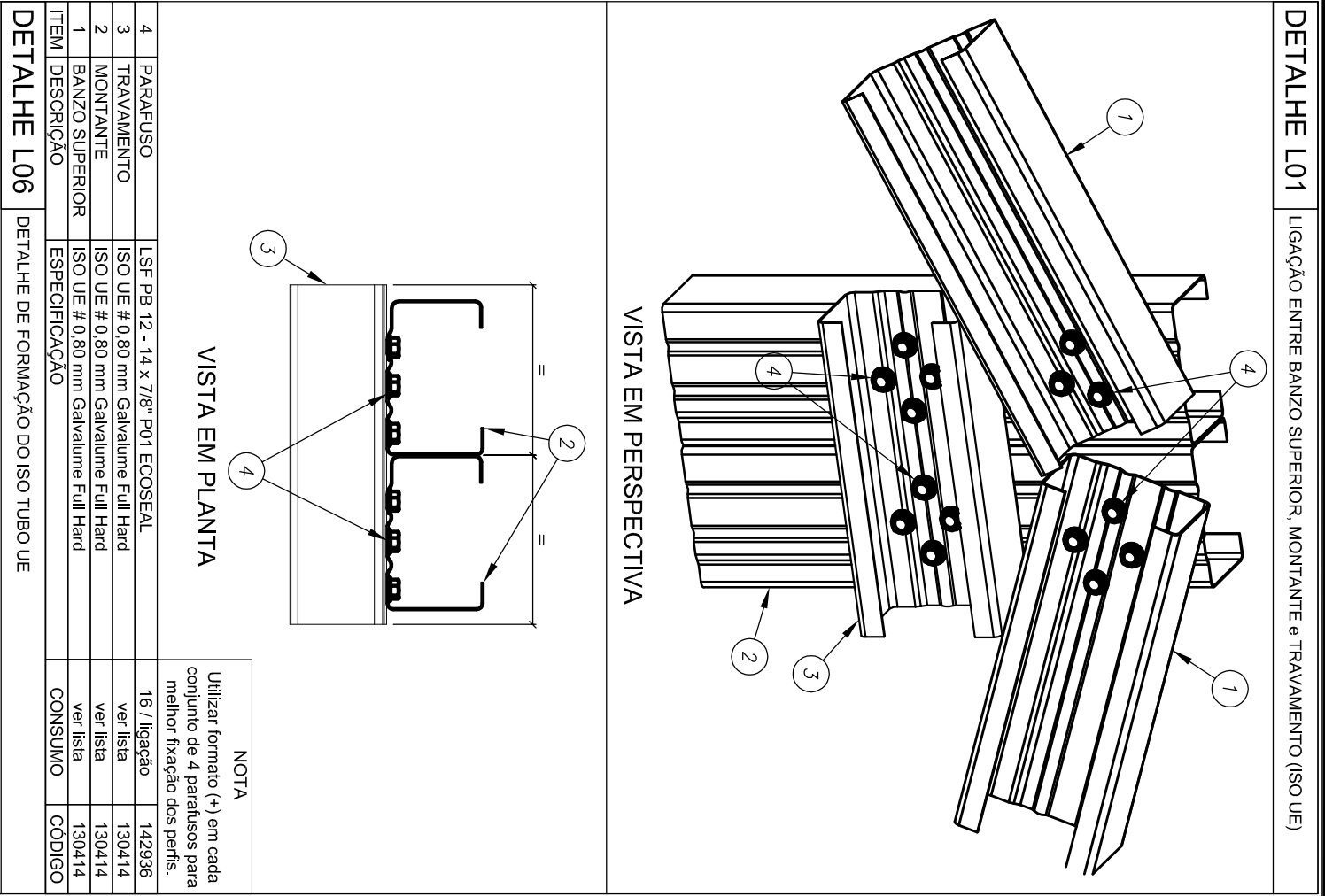

DETALHE L.15 | LIGAÇÃO DO CONTRAFRAMEAMENTO (ISO CARI) NO MONTANTE (Z-X ISO UE)

3	PRADEUSO	ISF-PB 12 - 14 x 7/8\" 701 ECOSEAL	4 / montante	142936
2	MONTANTE	ISO C&R 2020 - Ø 80 mm Galvalume e-1 Hard	vál lista	130415
1	BRAÇADURA	ISO C&R 2020 - Ø 80 mm Galvalume roll bend	CORROSÃO	COBRUDO

DETALHE M02

REFORÇO DE RAÇÃO DA VIGA METÁLICA NO PILAR DO CLIENTE

LEGENDA: 1. BARRAS DE AÇO

PILAR DE CONCRETO

REFORÇO DE RAÇÃO DA VIGA METÁLICA NO PILAR DO CLIENTE

LEGENDA: 1. BARRAS DE AÇO

DETALHE M01

REFORÇO DE RAÇÃO DA VIGA METÁLICA NO PILAR DO CLIENTE

LEGENDA: 1. BARRAS DE AÇO

SITUAÇÃO ENTRE ESTRUTURA E ALVENARIA

Apenas Apoiado

CONSUMO: 1 q / 1 metro

Distância entre Montantes
 $m=500$, máx=520

Platibanda em alvenaria com reboco

Nº	DESCRIÇÃO	Especificação	Quantidade	Código
1	BARRA ROSCA-ALV. TIPO 1	1 pç. 500 mm	145592	
2	SUporte DA CALHA	1 pç. 3 mm	145592	

LISTADE TELHAS - CRECHE TIPO 2 - BLOCO C				
ITEM	TAG	PERFIL	COMPRIMENTO (mm)	QNTD.
1	T8	ISOTELHA PIR 30MM	6020	14

FNDE *Fundo Nacional
de Desenvolvimento
da Educação*

Ministério da
Educação

DLFO	CREA

OBSERVAÇÕES:

PROGRAMA PROINFANCIA - PROJETO TIPO 2	COOPERAÇÃO CCEST - Coordenação Geral de Infraestrutura Educativa	ESTRUTURA METÁLICA PLANTA DE TELHAS E ELEVAÇÕES BLOCO A, BLOCO B BLOCO C	SMT
PROJETO DE ESTRUTURA	REVISÃO R.00 R.01 R.02	ESCALA 1/75	PRÁTICA 09/10
PROJETO A1 (15964651)			

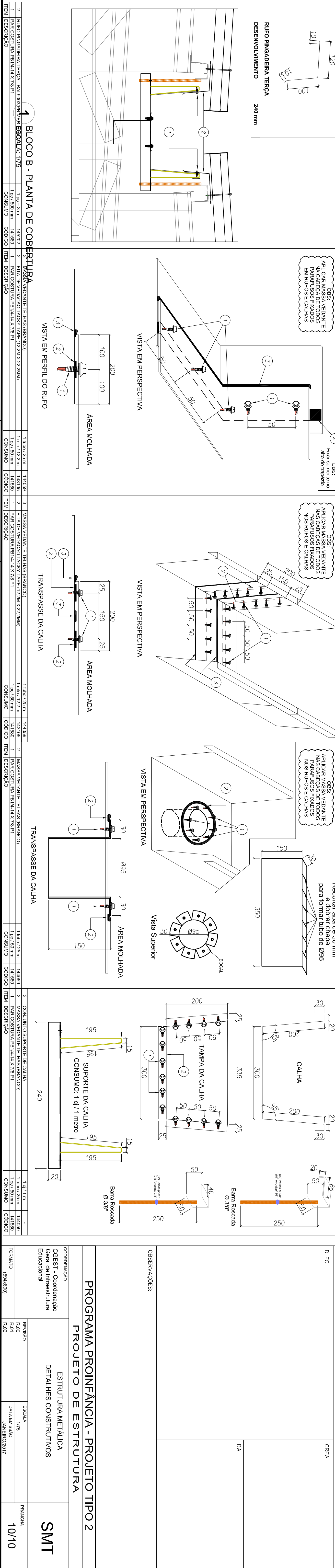
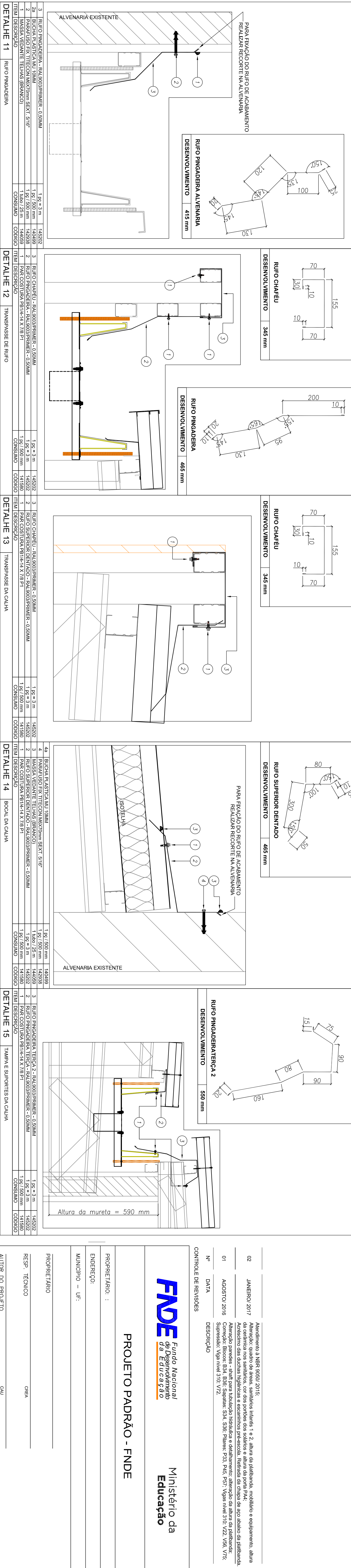
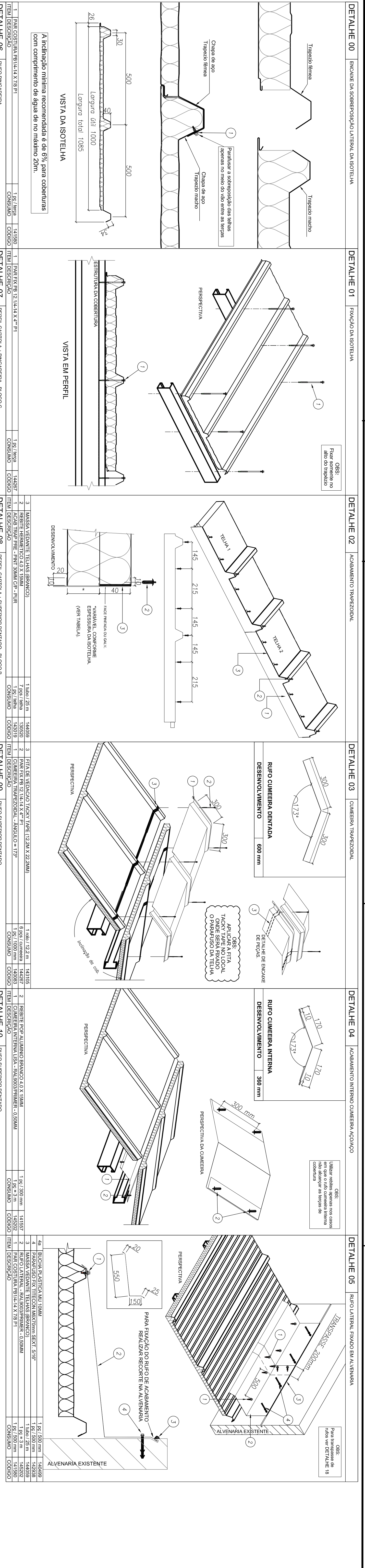

PROGRAMA PROINFANCIA - PROJETO TIPO 2			
PROJETO DE ESTRUTURA			
CONTENÇÃO		ESTRUTURA METÁLICA	
COST - Construção Educacional		DETALHES CONSTRUTIVOS	
PROJETO		SMT	
R.02		10/10	